

# Labeling & Signage

Basket Tags

Self-Looping Labels

Adhesive Labels

Transport Labels



Label Guns

Wall & Floor Signs



Intelligent Solutions  
for Instrument Care &  
Infection Control

[hmark.com](https://hmark.com)

-  Cleaning Monitoring
-  Cleaning Chemistries
-  Protective Equipment
-  **Labeling & Signage**
-  Instrument Care
-  Sterilization Products
-  Storage Products
-  Instrument Trays
-  Security Products

### Tray Identification Tags

For barcode labels & handwritten notes

These resin-bonded tags are designed for tray identification and may be used with barcode labels or hand written notes. They can remain with the sterilization basket throughout the collection, decontamination and sterilization process.



Item Number		Color	Width	Length	Qty	
<b>A</b>	TG011	Tray Identification Tag	White	3.50"	1.50"	EA, 100
<b>B</b>	TG012	Tray Identification Tag	Tan	3.50"	1.50"	EA, 100
<b>C</b>	TG013	Tray Identification Tag	Yellow	3.50"	1.50"	EA, 100
<b>D</b>	TG014	Tray Identification Tag	Orange	3.50"	1.50"	EA, 100
<b>E</b>	TG015	Tray Identification Tag	Red	3.50"	1.50"	EA, 100
<b>F</b>	TG016	Tray Identification Tag	Blue	3.50"	1.50"	EA, 100
<b>G</b>	TG017	Tray Identification Tag	Green	3.50"	1.50"	EA, 100
<b>H</b>	TG018	Tray Identification Tag	Grey	3.50"	1.50"	EA, 100
<b>I</b>	TG019	Tray Identification Tag	Purple	3.50"	1.50"	EA, 100
<b>J</b>	TG020	Tray Identification Tag	Black	3.50"	1.50"	EA, 100
<b>K</b>	TG021	Tray Identification Tag	Lime	3.50"	1.50"	EA, 100
<b>L</b>	TG022	Tray Identification Tag	Pink	3.50"	1.50"	EA, 100
<b>M</b>	TG023	Tray Identification Tag	Turquoise	3.50"	1.50"	EA, 100
<b>N</b>	TG024	Tray Identification Tag	Mustard	3.50"	1.50"	EA, 100
<b>O</b>	TG025	Tray Identification Tag	Terracotta	3.50"	1.50"	EA, 100
<b>P</b>	TG026	Tray Identification Tag	Royal Blue	3.50"	1.50"	EA, 100
<b>Q</b>	TG001	Tray Identification Tag	White	3.50"	2.20"	EA, 100
<b>R</b>	TT-002	Stainless Steel Tray Tag	Stainless Steel	3.50"	2.00"	EA
<b>S</b>	RING001	Stainless Steel Ring	Stainless Steel	25mm	25mm	100
<b>T</b>	TIE003	Plastic Tie	Light Blue	0.14"	5.91"	100

### Clip-On Basket Tags

Differentiate between instrument sets

Made of tough polypropylene, these tags are able to withstand heat up to 134°C (275 F) and are available in a variety of colors. Clip-On Basket tags are compatible with steam, gas, or plasma sterilization.

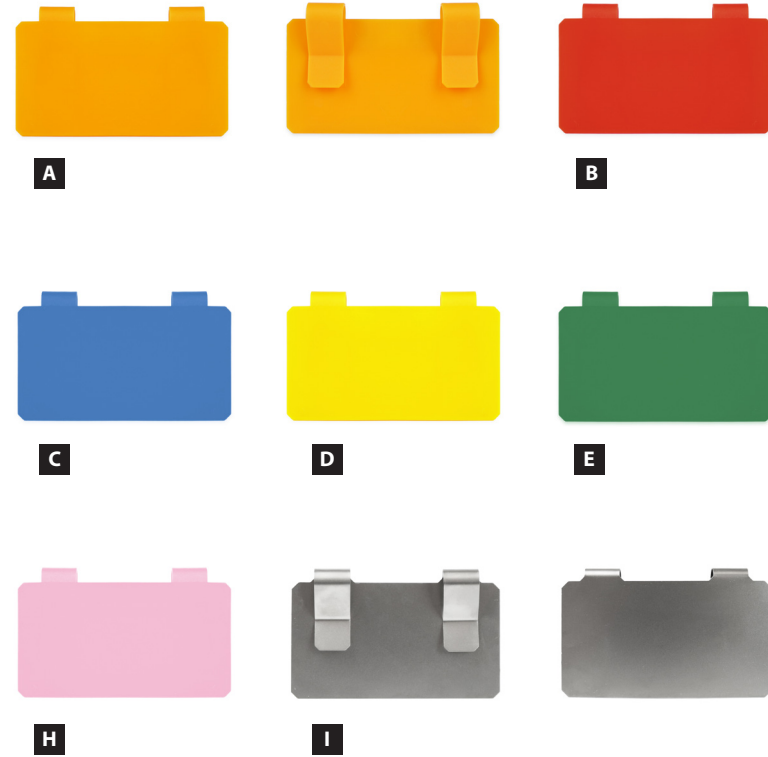

Item Number	Description	Color	Length	Width	Qty	
A	CBTOR	Clip-On Basket Tag	Orange	3.50"	2.00"	EA, 25
B	CBTRD	Clip-On Basket Tag	Red	3.50"	2.00"	EA, 25
C	CBTBL	Clip-On Basket Tag	Blue	3.50"	2.00"	EA, 25
D	CBTYL	Clip-On Basket Tag	Yellow	3.50"	2.00"	EA, 25
E	CBTGN	Clip-On Basket Tag	Green	3.50"	2.00"	EA, 25
F	CBTBK	Clip-On Basket Tag	Black	3.50"	2.00"	EA, 25
G	CBTPP	Clip-On Basket Tag	Purple	3.50"	2.00"	EA, 25
H	CBTPK	Clip-On Basket Tag	Pink	3.50"	2.00"	EA, 25
I	TT-001	Clip On Basket Tag - Stainless Steel	Stainless Steel	3.50"	2.00"	EA

### Hanging Tag

Affix to containers with tamper-evident seals

Designed to be used with container systems, Hanging Tags provide an ideal surface for barcode labels. Simply slide the tamper evident seal through cross-slot and affix to the container. Hanging Tags are single-use, non-adhesive and heat resistant up to a temperature of 275° F.

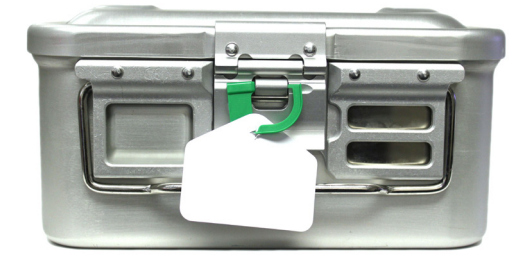

A

### Loaner & Vendor Tray Labels

Document information & attach to trays

Both the Loaner & Vendor Tray Labels consist of the following: 500 tray label tags, 500 autoclavable zip ties, and 1 marker. The tags and zip ties are single use and can be autoclaved in cycles 132°C for 4 minutes or 135°F for 3 minutes.



Item Number	Description	Color	Length	Width	Qty	
A	HT-001	Hanging Tag	White	1.90"	3.50"	1000
B	LN-TL	Loaner Tray Label	Green	3.00"	5.00"	500 Tray Labels, 500 Zip Ties, 1 Marker
C	VND-TL	Vendor Tray Label	Blue	3.00"	5.00"	500 Tray Labels, 500 Zip Ties, 1 Marker

### Laser C.A.A.T's

Custom-engraved anodized aluminum tags

Laser C.A.A.T's are laser engravable, high quality, anodized aluminum tags. They can be used to identify a variety of items like trays, baskets and containers. They can be engraved with any message specific to your department needs.





 **Customize**  
Engrave text/numbers





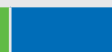
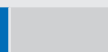

**1.5" Round Color Options**

			
Red	Green	Blue	Silver
			
Purple	Gold	Orange	

**2.0" Round Color Options**

			
Red	Green	Blue	Silver
			
Purple	Orange		

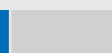
**2x3" Rectangle Color Options**

			
Red	Blue	Silver	Gold
			
Black			

	Item Number	Description	Color	Length	Width	Qty
<b>A</b>	15RBL	Laser CAAT - Round, Small	Blue	1.50"	1.50"	10
	15ROR	Laser CAAT - Round, Small	Orange	1.50"	1.50"	10
	15RGN	Laser CAAT - Round, Small	Green	1.50"	1.50"	10
	15RPP	Laser CAAT - Round, Small	Purple	1.50"	1.50"	10
	15RRD	Laser CAAT - Round, Small	Red	1.50"	1.50"	10
	15RSV	Laser CAAT - Round, Small	Silver	1.50"	1.50"	10
	15RGD	Laser CAAT - Round, Small	Gold	1.50"	1.50"	10
	20RBL	Laser CAAT - Round, Large	Blue	2.00"	2.00"	10
	20ROR	Laser CAAT - Round, Large	Orange	2.00"	2.00"	10
<b>B</b>	20RGN	Laser CAAT - Round, Large	Green	2.00"	2.00"	10
	20RPP	Laser CAAT - Round, Large	Purple	2.00"	2.00"	10
	20RRD	Laser CAAT - Round, Large	Red	2.00"	2.00"	10
	20RSV	Laser CAAT - Round, Large	Silver	2.00"	2.00"	10
	23RCBL	Laser CAAT - Rectangular	Blue	3.00"	2.00"	10
	23RCBK	Laser CAAT - Rectangular	Black	3.00"	2.00"	10
	23RCSV	Laser CAAT - Rectangular	Silver	3.00"	2.00"	10
	23RCGD	Laser CAAT - Rectangular	Gold	3.00"	2.00"	10
	<b>C</b>	23RCRD	Laser CAAT - Rectangular	Red	3.00"	2.00"
<b>D</b>	HOG RINGS	Hog Ring - 0.75"	Stainless Steel	0.75"	0.75"	EA
	HOG RING 1IN	Hog Ring - 1.00"	Stainless Steel	1.00"	1.00"	EA
	HOG RING 1.5IN	Hog Ring - 1.50"	Stainless Steel	1.50"	1.50"	EA

### Indicator HangTime Labels

Easy activation indicator shows elapsed time

Indicator HangTime Labels are offered with a 1 Hour, 7 Day or 12 Day time indicator adhered to a self-looping label, allowing for quick and ongoing observable clarification of how long it's been since an endoscope has been processed. The label allows staff to document the scope serial number and healthcare worker initials, as well as the date and time the indicator was activated. To activate the indicator, firmly press the blister on the strip, and a safe dye migrates along a display run-out window, which shows elapsed time.



### HangTime Labels

Document when a scope was last processed

HangTime Labels are designed to assist healthcare workers with tracking the day and month when the scope was last processed. They also include fields for the Scope Serial Number and Initials. They are available in green, yellow, pink, orange, blue and white.



### Flexible Endoscope Label

Document scope processing details

Flexible Endoscope Labels are sure to be the solution to managing scope reprocessing and ensuring quality patient care. This self-looping label includes fillable fields for important details and a space to place a patient sticker.



### Eye Wash Temperature Check Tag

Document weekly maintenance checks

Eye Wash Temperature Check Tags assist healthcare workers with verifying that the water of their facilities' eye wash station is within a tepid temperature range. Attached to a 36" nickel-plated ball chain to hang from eye wash stations, the front features a log for individuals to document weekly maintenance checks of their facilities eye wash station. The back features a liquid crystal thermometer, along with the recommended water temperature range of 16-38°C (60-100°F).

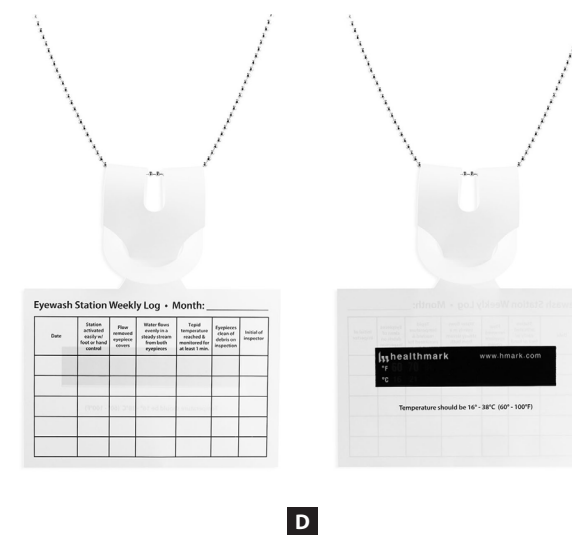

	Item Number	Description	Color	Length	Width	Qty
A	HTK-1H2	1-Hour Indicator HangTime Label	Yellow	8.50"	2.50"	100
	HTK-7D2	7-Day Indicator HangTime Label	Green	8.50"	2.50"	100
	HTK-12D	12-Day Indicator HangTime Label	Blue	8.50"	2.50"	100
B	403225-HTKG	HangTime Label	Green	8.50"	2.50"	100, 500
	403225-HTKY	HangTime Label	Yellow	8.50"	2.50"	100, 500
	403225-HTKP	HangTime Label	Pink	8.50"	2.50"	100, 500
	403225-HTKO	HangTime Label	Orange	8.50"	2.50"	100, 500
	403225-HTKB	HangTime Label	Blue	8.50"	2.50"	100, 500
	403225-HTK	HangTime Label	White	8.50"	2.50"	100, 500
C	404225-351-GI	Flexible Endoscope Label	White	13.00"	2.50"	500
D	EWTC-001	Eye Wash Temperature Check Tag	White	9.00"	5.00"	12 Tags, 1 Chain

### Biohazard Label

Clearly label hazardous materials

This self-looping Biohazard Label features the universally recognized biohazard symbol, indicating the presence of potentially infectious materials. It is ideal for use on containers, trays or carts holding contaminated instruments to help clearly communicate to staff that the items require extra caution when handling.

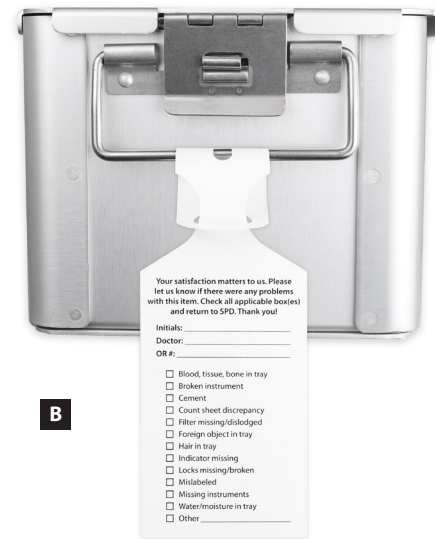

### Quality Audit Tray Label

Track quality defects with instrument trays

Designed to help SPDs track and trend quality defects with instrument trays, the Quality Audit Tray Label allows the end-user of instruments to report an observed tray defect by making a tic mark in the corresponding check box, which is then returned to SPD leadership for tracking and quality improvement purposes. The front portion allows staff to document critical information including the doctor's initials and name, as well as the operating room number and identified problem. The back features a space for healthcare workers to adhere an instrument tracking label.



### Self-Tie Container Tag

Large, blank tag for sterilization containers

Compatible with various tracking and tracing systems, the container tag serves to identify contaminated containers when self-adhesive labels cannot be utilized. Made to withstand automatic washers and steam sterilization, the large container tag is latex free and can be attached onto the handle(s) of multiple sterilization containers.

### Loaner Label

Identify loaner equipment & record details

The self-looping Loaner Label is designed to help the SPD identify loaner equipment, record information about loaner equipment, and track loaner equipment throughout the sterilization process.

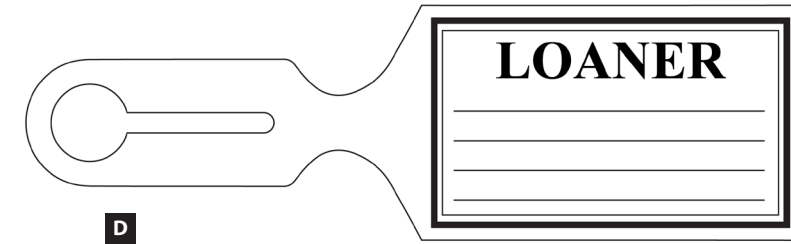

### Preprinted Tray Label

Differentiate between instrument sets

The Preprinted Tray Label is designed for registering sterilized items, enabling recall of all items if necessary. These PP-based labels are resistant to disinfection, washing and sterilization. Includes fillable fields for the CSSD and the OR.

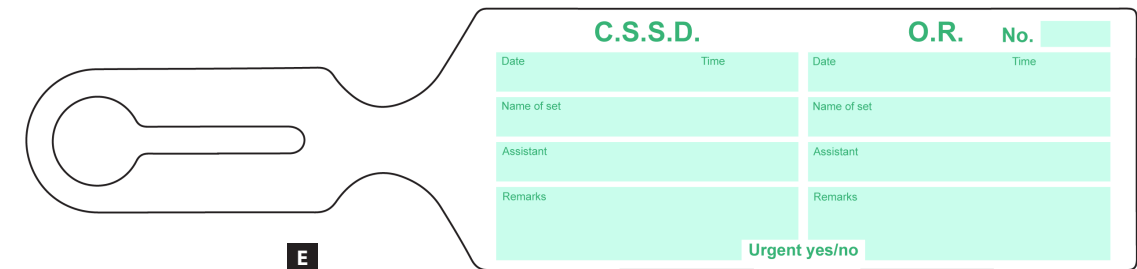

	Item Number	Description	Color	Length	Width	Qty
<b>A</b>	403225-RD-BIO	Self-Looping Tray Label - Biohazard	Red	8.50"	2.50"	500
<b>B</b>	403225 QAT	Quality Audit Tray Label	White	8.50"	2.50"	500
<b>C</b>	STT-001	Self-Tie Container Tag	White	11.00"	3.75"	Roll-250
<b>D</b>	403225 LNR	Self-Looping Tray Label - Loaner	White	8.50"	2.50"	500
<b>E</b>	403125	Self-Looping Tray Label - Preprinted	White	9.50"	2.00"	500

### Self-Looping Tray Labels

Available blank or custom-printed

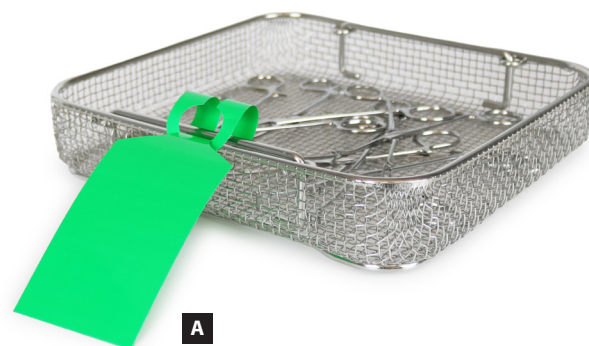

Self-Looping Tray Labels facilitate specific markings and remarks for sterile or contaminated instrument trays. The PP-based label is suitable for sterilization and resistant to washing and disinfection and thus can stay with a tray of instruments all the way through the decontamination process. Create your own Self-Looping Tray Label with the color and message of your choice!



Item Number	Description	Color	Length	Width	Qty
403225	Self-Looping Tray Label	White	8.50"	2.50"	500
403225 BL	Self-Looping Tray Label	Blue	8.50"	2.50"	500
<b>A</b> 403225 GN	Self-Looping Tray Label	Green	8.50"	2.50"	500
403225 BK	Self-Looping Tray Label	Black	8.50"	2.50"	500
403225 OR	Self-Looping Tray Label	Orange	8.50"	2.50"	500
403225 YL	Self-Looping Tray Label	Yellow	8.50"	2.50"	500
403225 PK	Self-Looping Tray Label	Pink	8.50"	2.50"	500
403225 RD	Self-Looping Tray Label	Red	8.50"	2.50"	500
403225 YL	Self-Looping Tray Label	Yellow	8.50"	2.50"	500
403225 BN	Self-Looping Tray Label	Brown	8.50"	2.50"	500
403225 FP	Self-Looping Tray Label	Fluorescent Pink	8.50"	2.50"	500
403225 LG	Self-Looping Tray Label	Lime Green	8.50"	2.50"	500
403225 LB	Self-Looping Tray Label	Light Blue	8.50"	2.50"	500
403225 PP	Self-Looping Tray Label	Purple	8.50"	2.50"	500
403225 VT	Self-Looping Tray Label	Violet	8.50"	2.50"	500



### Custom Vinyl Labels

Durable, custom-printed, two-color labels

Custom Vinyl Labels are available as magnetic or adhesive. Both options are made from durable, industrial-grade vinyl that will endure even harsh environments. Custom Vinyl Labels can withstand temperatures ranging from -40°F to 200°F and are UV, water, chemical and smear resistant. Material and text color options are: Red, Orange, Yellow, Green, Blue, Black and White.



Item Number	Length	Width	Qty
CVL14	1.00"	4.00"	EA
CVL16	1.00"	6.00"	EA
CVL18	1.00"	8.00"	EA
CVL112	1.00"	12.00"	EA
CVL24	2.00"	4.00"	EA
CVL26	2.00"	6.00"	EA
CVL28	2.00"	8.00"	EA
CVL212	2.00"	12.00"	EA
CVL34	3.00"	4.00"	EA
CVL36	3.00"	6.00"	EA
CVL38	3.00"	8.00"	EA
CVL312	3.00"	12.00"	EA
CVL44	4.00"	4.00"	EA
CVL46	4.00"	6.00"	EA
CVL48	4.00"	8.00"	EA
CVL412	4.00"	12.00"	EA



Item Number	Length	Width	Qty
CVL55	5.00"	5.00"	EA
CVL56	5.00"	6.00"	EA
CVL58	5.00"	8.00"	EA
CVL512	5.00"	12.00"	EA
CVL66	6.00"	6.00"	EA
CVL68	6.00"	8.00"	EA
CVL612	6.00"	12.00"	EA
CVL76	7.00"	6.00"	EA
CVL77	7.00"	7.00"	EA
CVL78	7.00"	8.00"	EA
CVL712	7.00"	12.00"	EA
CVL88	8.00"	8.00"	EA
CVL812	8.00"	12.00"	EA
CVL96	9.00"	6.00"	EA
CVL98	9.00"	8.00"	EA
CVL99	9.00"	9.00"	EA
CVL912	9.00"	12.00"	EA

### Adhesive Message Labels

Choose stock options or design your own

Preprinted Message Labels include many of the most frequently requested messages, stocked and ready for you. Healthmark also offers Custom Message Labels available in multiple adhesive types, and any size and color combination.

**Customize**  
Printing, Color, Size, Adhesive Type

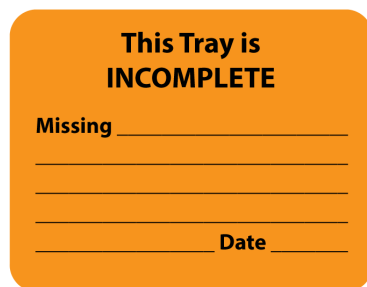

C



A



D



B



E



F



G

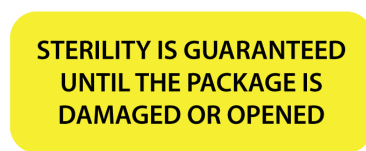

H

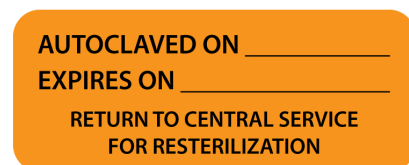

I



J



K



L

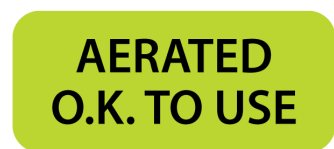

M



N



O



P

### Washer Rack Labels

Like a license plate for your washer rack



Q

Washer Rack Labels are used to identify and track washer racks through the washing cycles. Like a license plate for your washer rack, each label has a unique human and machine readable alphanumeric number. Made with anodized aluminum and robust adhesive backing, they are designed to withstand repeated washing cycles.

	Item Number	Description	Color	Length	Width	Qty
A	CSW-RRS	"Reusable: Return to SPD" Labels	Black on Yellow	2.25"	0.875"	500 / Roll
B	CSW-RCS	"Return to Central Supply" Labels	Black on Red	2.25"	.875"	500 / Roll
C	CSW-302	"This Tray Is Incomplete" Labels	Black on Orange	2.25"	1.75"	500 / Roll
D	CSW-SPU	"Single Patient Use Only Then" Labels	Black on Orange	2.25"	.875"	420 / Roll
E	CSW-116	Expiration Date Labels	Black on Green	2.25"	0.875"	500 / Roll
F	CSW-1212	"Warning Gas Sterilize Only" Labels	Black on Red	2.50"	1.00"	1000 / Roll
G	CSW-SSS	"Sterrad System Sterilized" Labels	Black on Orange	2.25"	0.875"	500 / Roll
H	CSW-254	"Sterility is Guaranteed..." Labels	Black on Yellow	2.25"	0.875"	500 / Roll
I	CSW-1215	"Autoclaved Expires On" Labels	Black on Orange	2.50"	1.00"	1000 / Roll
J	DC-100214-71-BL	"High Level Disinfected" Labels	Black on Blue	2.25"	1.00"	1000 / Roll
K	CSW-113	"Dust Cover This Item" Labels	Black on Pink	2.25"	1.00"	500 / Roll
L	CSW-IMP	"Implantable" Labels	Black on Red	3.00"	0.875"	320 / Roll
M	CSW-165	"Aerated OK to Use" Labels	Black on Green	2.00"	0.875"	500 / Roll
N	CSW-1216	"Sterilized: Indefinite Shelf Life..." Labels	Green on White	2.50"	1.00"	1000 / Roll
O	BIO-1X1	Biohazard Labels - Sheet of 16	Black on Orange	1.00"	1.00"	1 Sheet of 16
P	BIO-3 X 3	Biohazard Label	Black on Orange	3.00"	3.00"	EA
Q	WRL-001	Washer Rack Labels - Anodized Aluminum	Black on White	2.00"	0.625"	10

### Clean Label

Removable label

The clean label is intended to conceal and cover the biohazard symbol on SST tray systems when transporting clean medical instruments. The label is a 4 x 4 Inch design with a removable adhesive backing that has a green colored background and "CLEAN" in white text. Prior to use, ensure the application surface area is dry and simply apply the label with firm thumb pressure.



A

### Multi-Purpose Equipment Label

Identify contents as Clean, In Use or Dirty

The Multi-Purpose Equipment Label was developed as a way to ensure consistency and identify whether medical equipment designated for patient use is either clean, in-use or dirty. It has a pull-tab style design with an adhesive backing that doesn't leave residue behind and can be applied to numerous medical devices, allowing individuals to correctly confirm the status of equipment.



B

### High Level Disinfected Label

Identify contents as Clean/HLD or Biohazard

Designed for containers that hold high-level disinfected or contaminated scopes, this label has a green top tab that reads "CLEAN AND HIGH LEVEL DISINFECTED", as well as a removable self-adhesive orange bottom tab that reads "BIOHAZARD" in black text and provides space to record the time the scope was pre-cleaned.



C

### Transportation Label

Available with or without transport checklist

This label is ideal for transporting materials considered biohazard, while acting as an essential communication tool in the process. By labeling a cart or container "biohazard" upon its return to the SPD, the Transportation Identification Tag assists in supplying information to the OR/Procedure Room. It has a check list for the surgical/procedure room/sterile processing team to ensure adequate delivery of the case cart or container in question. Also available without the checklist.



D

### Quick Turnover Label

Identify the status of contents

This label has two perforated tabs; a green tab with "TRANSPORTATION TAG" and a red bottom with "QUICK TURNOVER" along with a space to indicate items and time needed, as well as a green tab with "CLEAN" in black text and a fluorescent orange bottom featuring a biohazard symbol with "DIRTY" and "BIOHAZARD" in black text.



E

	Item Number	Description	Color	Length	Width	Qty	
	A	CLN-4X4	Clean Label	Green	4.00"	4.00"	500
	B	HM-CID-613	Multi-Purpose Equipment Label	Green/Yellow/Red	2.00"	3.00"	250
	C	HM-52483-HLD	High Level Disinfected Label	Green/Orange	2.00"	3.00"	250
	D	AV-52481	2 Part Clean/Dirty Label with Checklist	Green/Orange	2.00"	3.00"	1000 / 250
		AV-52482	2 Part Clean/Dirty Label without Checklist	Green/Orange	2.00"	3.00"	1000 / 250
	E	HM-52489	Quick Turnover 2-Part Clean/Dirty Label	Green/Red/Orange	2.00"	3.00"	250



### Insta Grid Panels

Magnetic & adhesive customizable grids

Insta Grids are ready to use in seconds. They are available for use on a magnetic board or peel & stick version for use on any whiteboard. Just stick on the board creating an instant grid. Insta Grids can be customized to any application including creating larger rectangles by cutting grid cells to size. Connect grids together to add columns and rows as needed.

SURGERY LINE-UP				4-19
O.R.	TIME	SURGEON	STATUS	PROCEDURE
7:30A	MARKS			
9:00A	JONES			
7:30A	STILLS			
9:30A	HANSON			
7:00A	KENT			
8:15A	CARLSON			
10:00A	KENT			
8:00A	MASON			
10:00A	MARKS			

OR. 1	OR. 3
OR. 2	OR. 4

A

Item Number	Description	Color	Length	Width	Qty
850	Magnetic Grid Panels	Red	23.00"	15.00"	6
851	Magnetic Grid Panels	Orange	23.00"	15.00"	6
852	Magnetic Grid Panels	Yellow	23.00"	15.00"	6
853	Magnetic Grid Panels	Green	23.00"	15.00"	6
<b>A</b> 854	Magnetic Grid Panels	Blue	23.00"	15.00"	6
855	Magnetic Grid Panels	Black	23.00"	15.00"	6
860	Peel & Stick Insta Grid Panels	Red	23.00"	15.00"	6
863	Peel & Stick Insta Grid Panels	Green	23.00"	15.00"	6
864	Peel & Stick Insta Grid Panels	Blue	23.00"	15.00"	6
865	Peel & Stick Insta Grid Panels	Black	23.00"	15.00"	6



### Magna Tags

Write custom messages on magnetic tags

Quickly label any magnetic surface with the Magna Tags. Attach your own label on the surface of the tag or write directly on the erasable surface with a magic marker. Magna Tags are offered in 6 different colors.



A

Item Number	Description	Color	Length	Width	Qty
870	Magna Tags	Red	3.50"	1.25"	24
871	Magna Tags	Orange	3.50"	1.25"	24
872	Magna Tags	Yellow	3.50"	1.25"	24
<b>A</b> 873	Magna Tags	Green	3.50"	1.25"	24
874	Magna Tags	Blue	3.50"	1.25"	24
875	Magna Tags	Black	3.50"	1.25"	24

### Labeling Tape

Write custom messages on removable tape

This tape readily accepts ballpoint, pencil or permanent markers. With a service temperature of -70°F to +250°F, it can be used in the freezer, refrigerator or incubator. This tape will stay put until you purposely remove it and comes off cleanly.

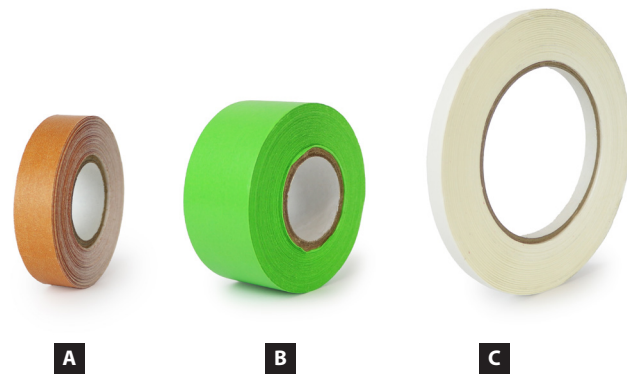

### Color Dots

Adhesive circles in a variety of sizes & colors

Dating, coding and categorizing is made simple with these Color Dots. Choose from a variety of sizes and 26 different color options. Apply Color Dots to trays, containers or any other key assets to help communicate information.



Item Number	Description	Length	Width	Qty
LT-514	Labeling Tape	500.00"	0.25"	Roll
<b>A</b> LT-512	Labeling Tape	500.00"	0.50"	Roll
LT-534	Labeling Tape	500.00"	0.75"	Roll
<b>B</b> LT-510	Labeling Tape	500.00"	1.00"	Roll
<b>C</b> LT-614	Labeling Tape	2160.00"	0.25"	Roll
LT-612	Labeling Tape	2160.00"	0.50"	Roll
LT-610	Labeling Tape	2160.00"	1.00"	Roll
LT-620	Labeling Tape	2160.00"	2.00"	Roll
<b>D</b> LDL-025	Color Dots - 0.25" Circle	0.25"	0.25"	1000
<b>E</b> LDL-050	Color Dots - 0.50" Circle	0.50"	0.50"	1000
<b>F</b> LDL-075	Color Dots - 0.75" Circle	0.75"	0.75"	1000
<b>G</b> LDL-100	Color Dots - 1.00" Circle	1.00"	1.00"	1000
<b>H</b> LDL-150	Color Dots - 1.50" Circle	1.50"	1.50"	1000
<b>I</b> LDL-200	Color Dots - 2.00" Circle	2.00"	2.00"	1000

Labeling Tape & Color Dot Color Options												
1	2	3	4	5	6	7	8	9	10	11	12	13
White	Yellow	Green	Red	Orange	Blue	Pink	Tan	Salmon	Copper	Rose	Violet	Lavender
14	15	16	17	18	19	20	21	22	23	24	25	26
Grey	Lime	Aqua	Chartreuse	Gold	Silver	Magenta	Dark Red	Maroon	Dark Brown	Dark Blue	Dark Green	Black

### Handheld Label Gun

For labeling packs, trays and pouches

Our Handheld Labeling System has been designed specifically with Central Sterile in mind for the labeling of any items that you need to be autoclaved - from sterile linen packs to instrument trays, and peel pouches. It also has great versatility for labeling in other hospital departments such as dietary and pharmacy. This system gives you the flexibility to print two lines of information with up to eight characters per line. The available characters include two Gregorian dates for printing expiration and autoclave dating with additional bands for load and sterilizer numbers.

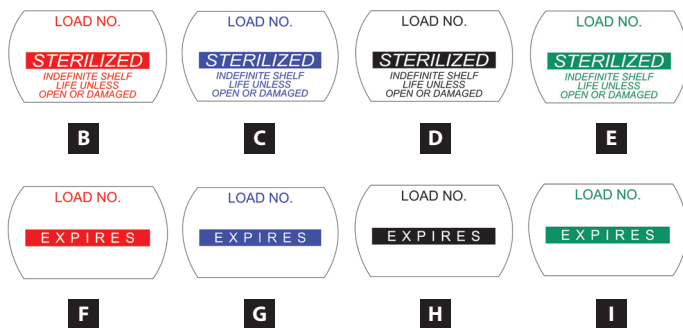

### Premium Handheld Label Gun

High-quality label system, two-part labels

A labeling system with two-part labels and a premium label gun. The label gun offers fast and simple drop-in loading, an accurate and precise label feed, clean and easy insertion and removal of the ink-roller, and a one-piece robust and resistant plastic housing for full coverage and protection of the label roll inside. The two-part labels were designed to allow the sterilization record label to go with the patient record after use. This will help facilities know exactly when an item was sterilized with each patient. These labels are available in both "Event related" labels and "Expiration" labels options with in 4 standard colors. All labels are steam and EtO compatible.

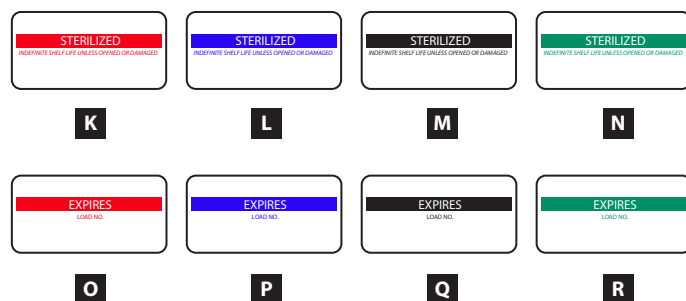

	Item Number	Description	Color	Compatibility	Qty	
	A	H-362026	Handheld Label Gun		EA	
	B	H369020	Event Related Labels	Red on White	Steam & EtO	12 Rolls (1315/Roll)
	C	H369021	Event Related Labels	Blue on White	Steam & EtO	12 Rolls (1315/Roll)
	D	H369023	Event Related Labels	Black on White	Steam & EtO	12 Rolls (1315/Roll)
	E	H369024	Event Related Labels	Green on White	Steam & EtO	12 Rolls (1315/Roll)
	F	H369012	Expiration Labels	Red on White	Steam & EtO	12 Rolls (1315/Roll)
	G	H369010	Expiration Labels	Blue on White	Steam & EtO	12 Rolls (1315/Roll)
	H	H369013	Expiration Labels	Black on White	Steam & EtO	12 Rolls (1315/Roll)
	I	H369014	Expiration Labels	Green on White	Steam & EtO	12 Rolls (1315/Roll)
		H369018	Blank Labels	White	Steam & EtO	12 Rolls (1315/Roll)
		H369018S	Blank Labels	White	Steam, EtO & Sterrad®	12 Rolls (1150/Roll)
		H369020S	Event Related Labels	Red on White	Steam, EtO & Sterrad®	12 Rolls (1020/Roll)
		H369021S	Event Related Labels	Blue on White	Steam, EtO & Sterrad®	12 Rolls (1020/Roll)
		H369023S	Event Related Labels	Black on White	Steam, EtO & Sterrad®	12 Rolls (1020/Roll)
		H369024S	Event Related Labels	Green on White	Steam, EtO & Sterrad®	12 Rolls (1020/Roll)
		H369010S	Expiration Labels	Blue on White	Steam, EtO & Sterrad®	12 Rolls (1020/Roll)
		H369012S	Expiration Labels	Red on White	Steam, EtO & Sterrad®	12 Rolls (1020/Roll)
		H369013S	Expiration Labels	Black on White	Steam, EtO & Sterrad®	12 Rolls (1020/Roll)
		H369014S	Expiration Labels	Green on White	Steam, EtO & Sterrad®	12 Rolls (1020/Roll)
	J	15.400.250	Premium Handheld Label Gun		EA	
	K	15.500.515	Event Related Dual-Layer Labels	Red on White	Steam & EtO	14 Rolls (650/Roll)
	L	15.500.516	Event Related Dual-Layer Labels	Green on White	Steam & EtO	14 Rolls (650/Roll)
	M	15.500.517	Event Related Dual-Layer Labels	Blue on White	Steam & EtO	14 Rolls (650/Roll)
	N	15.500.518	Event Related Dual-Layer Labels	Black on White	Steam & EtO	14 Rolls (650/Roll)
	O	15.500.519	Expiration Dual-Layer Labels	Red on White	Steam & EtO	14 Rolls (650/Roll)
	P	15.500.523	Expiration Dual-Layer Labels	Green on White	Steam & EtO	14 Rolls (650/Roll)
	Q	15.500.524	Expiration Dual-Layer Labels	Blue on White	Steam & EtO	14 Rolls (650/Roll)
	R	15.500.525	Expiration Dual-Layer Labels	Black on White	Steam & EtO	14 Rolls (650/Roll)

### Floor Signs

Durable strength & long-lasting adhesive

With UV protected industrial laminate materials, these high-impact floor signs will last up to 7 years without losing their top-layer traction or their color. They offer clear printing and high visibility and they are quick and easy to use.



A



B



C



D



E



F



G



H



I

Item Number	Description	Length	Width	Qty
A	FS-EW Floor Sign - Eye Wash Station	24.00"	24.00"	EA
B	FS-FE-DNB Floor Sign - Fire Extinguisher, Do Not Block	24.00"	24.00"	EA
C	FS-FLL Floor Sign - Door Swing Area	72.00"	36.00"	EA
D	FS-PPEREQB Floor Sign - PPE Required	24.00"	24.00"	EA
E	FS-SLIP Floor Sign - Caution, Slippery When Wet	30.00"	21.00"	EA
F	FS-SLW Floor Sign - Slow, Approach Door with Caution	30.00"	21.00"	EA
G	FS-STP-AUTH Floor Sign - Stop, Authorized Personnel Only	24.00"	24.00"	EA
H	FS-STP-BAS Floor Sign - Stop Sign	24.00"	24.00"	EA
I	STA01 Floor Sign - Arrows	10.00"	3.50"	25

### Clean/Dirty Reversible Signs

Magnetic holder with reversible sign

These signs are a reversible design, one side colored red with a white biohazard symbol, the other side green with "CLEAN" in white lettering. Included with each sign is a reusable vinyl magnetic holder that can be easily repositioned and affixed to various racks, carts, trolleys where applicable. The magnetic holder and reversible signs can be purchased separately as replacements.



A

### Stainless Steel Time Out Sign

Compact, stainless steel Time Out reminder

A "Surgical Pause" is the universal protocol for preventing wrong site, wrong procedure, and wrong person surgery. This sign serves as a perfect reminder. The 1" x 5" dimensions make this sign visible to read, yet still compact and light. The sign can be sterilized individually or be included inside with a set of instruments. The 304 grade stainless is materially compatible with steam, EtO & gas-plasma sterilization.



B

Item Number	Description	Length	Width	Qty
2024-4060	Clean/Dirty Reversible Sign	3.75"	5.75"	EA
2022-7555	Clean/Dirty Reversible Sign	7.50"	5.50"	EA
A 2023-1058	Clean/Dirty Reversible Sign	10.50"	8.00"	EA
S-2022	Magnetic Label Holder	5.50"	8.50"	EA
S-2023	Magnetic Label Holder	8.50"	11.00"	EA
S-2024	Magnetic Label Holder	6.00"	4.00"	EA
CD-2022	Clean/Dirty Reversible Sign - SEALED	5.50"	8.50"	EA
CD-2023	Clean/Dirty Reversible Sign - SEALED	8.50"	11.00"	EA
CD-2024	Clean/Dirty Reversible Sign - SEALED	6.00"	4.00"	EA
B SS-TO	Stainless Steel Time Out Sign	5.00"	1.00"	EA

### Fine Signs

Choose stock options or design your own

Fine Signs are a great way to communicate messages throughout your department. Choose from an array of stock signs or design a custom sign with your own message. Ensure visitors and employees are aware of important messages.

 **Customize**  
Message, Color, Size



A



B



C



D



E



F



G



H



I



J

	Item Number	Description	Length	Width	Qty
A	FS1624-TO	Fine Sign - Time Out	16.00"	24.00"	EA
B	FS1624-BIO	Fine Sign - Biohazard	16.00"	24.00"	EA
C	FS2424-KAC	Fine Sign - Keep Aisle Clear	24.00"	24.00"	EA
D	FS2424-STP	Fine Sign - STOP No Admittance w/o Proper Attire	24.00"	24.00"	EA
E	FS2412-EW	Fine Sign - Emergency Eye Wash	24.00"	12.00"	EA
F	FS2412-CEIL	Fine Sign - Keep Items Away from Ceiling	24.00"	12.00"	EA
G	FS2412-PPE	Fine Sign - All Employees Must Wear PPE	24.00"	12.00"	EA
H	FS2406-P&P	Fine Sign - Policies & Protocols	24.00"	6.00"	EA
I	FS2424-LABCOAT	Fine Sign - Street Clothes & Lab Coats Not Allowed	24.00"	24.00"	EA
J	FS2424-RSTR	Fine Sign - Restricted Area	24.00"	24.00"	EA



A Getinge company

Intelligent Solutions  
for Instrument Care &  
Infection Control

[hmark.com](http://hmark.com)

## Healthmark Industries Co. Inc.

18600 Malyn Blvd.

Fraser, Michigan 48026

USA

## Call Us

Toll Free: 800.521.6224

International: +1.586.774.7600

Fax: 586.491.2113

## Email Us

Contact: [healthmark@hmark.com](mailto:healthmark@hmark.com)

Order Inquiries: [hmorders@hmark.com](mailto:hmorders@hmark.com)

